



NICHE LIGHT TROUBLE SHOOTING MANUAL



FAQ & TROUBLE SHOOTING GUIDE



WHAT IS LED LIGHTING?

LED lighting is a new lighting technology which uses much less energy and lasts much longer than traditional light sources. Additional benefits are lower heat output, zero infra red radiation, ease of installation and many more.

CAN I INSTALL YOUR PRODUCTS MYSELF?

Sunline LED pool lights are easy to install and in many cases operate on safe low-voltages, however we always recommend that any lighting or electrical installation be carried out by a suitable licensed electrician

MY LIGHTS AREN'T SYNCING?

This only applies if there are 2 more lights in the pool. To reset the unit power to the lights needs to be turned off and on for 3 seconds

IT'S COMPLETELY DEAD!

- Check if power is on
- Check fuse box
- Check that all relevant cables are connected
- If all above is correct and the unit is still not working - Contact Sunline

THE FRONT FACE KEEPS FALLING OFF

Twist and turn the cover plate in place, if it still falls off The connecting lugs may be broken - if so replacement ones are available - Contact Sunline

THE COLOURS AREN'T CONSISTENT

When installing more than 1 x Pool light, colour may vary from Light to Light, mainly caused from refraction.

THE LENSE IS FULL OF WATER

For whatever reason, water has breached the sealed unit. Contact Sunline for a replacement. If your light is in within warranty make sure you have your proof of purchase.

HOW LONG DO THEY LAST?

Long life – LED life span of over 70,000 hours



CHANGING THE COLOUR MODE

With the light power on, the light must be switched off and back on within 2 seconds, the light will then change to the next colour mode. When it changes to the last colour mode, it will come back to Mode 1.

CHANGING TWO OR MORE LED LIGHTS COLOUR MODES TO THE SAME MODE

No matter what colour mode the LED lights are on, by switching ON and OFF three times (within 3 seconds), all of the LED lights will be changed to Mode 1.

LED lamps are pre-programmed with 7 lighting modes. The 7 modes are as follows:

- a) Green
- b) Green/Red
- c) Blue/Green/Red
- d) Multiple fading in and out 5. Rotating colours
- e) Blue
- f) Blue/Red
- g) Blue/Green



NICHE LIGHT DIMENSIONS

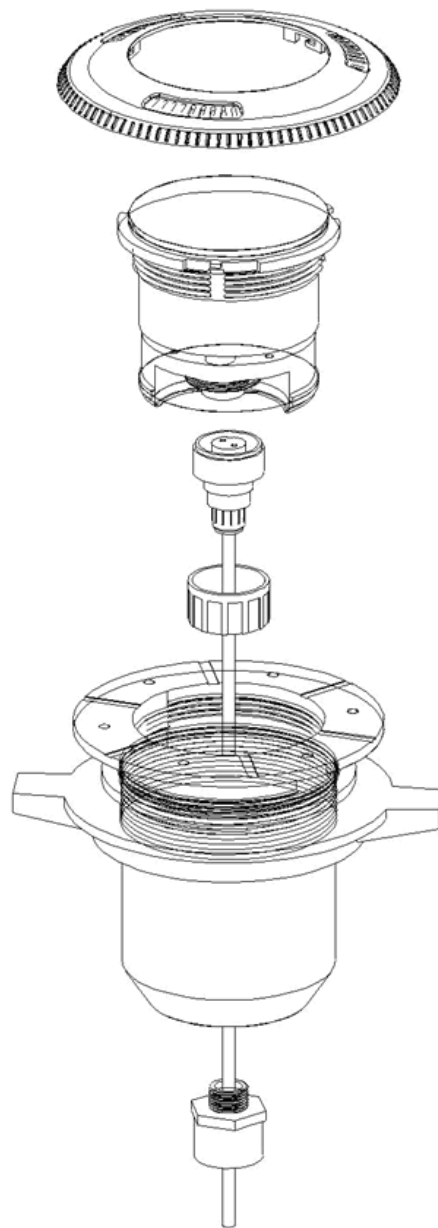
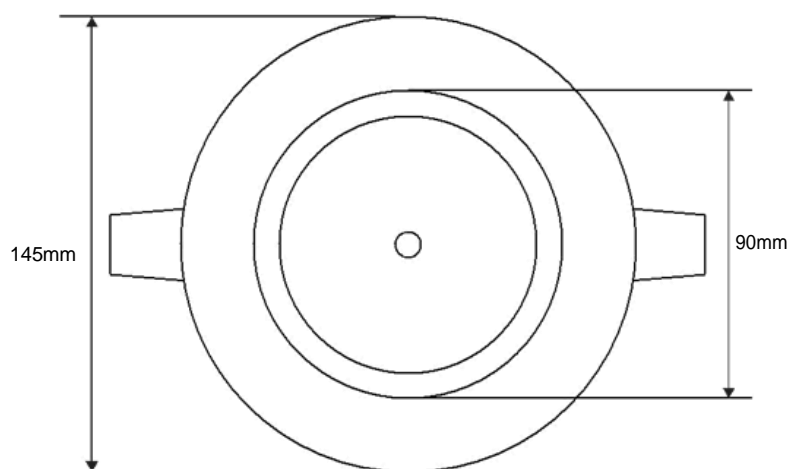
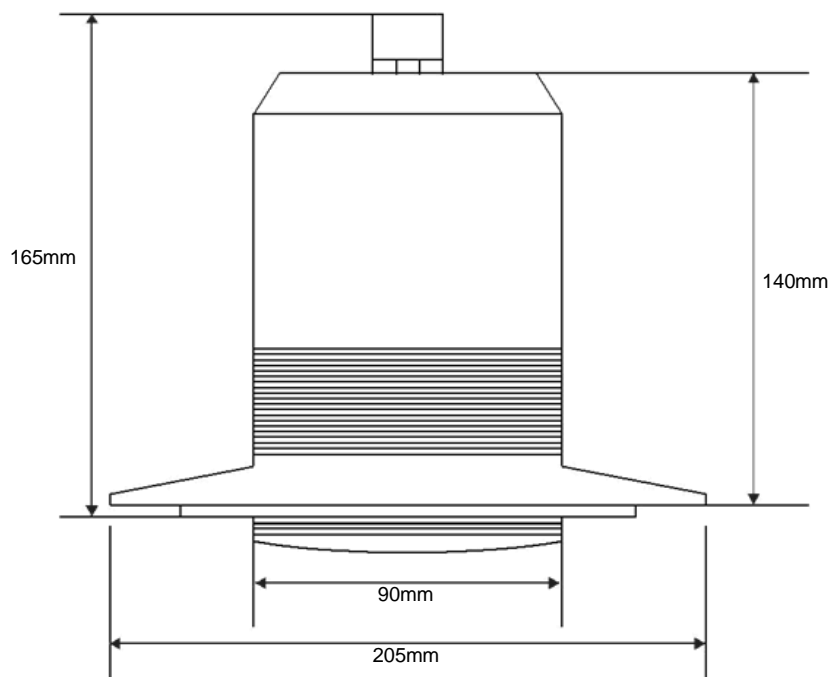

SPECIFICATIONS

Bright high intense LEDS deliver maximum brightness with the lowest power consumption (energy efficient) Input: 240V-AC 50Hz | Output: 12V-AC 50Hz.

Niche concrete pool, multi coloured model number: **SL-LED M-C: LED** Niche fibreglass pool, multi coloured model number: **SL-LED M-F: LED**

HERTZ

50

OUTPUT

12V

INPUT

245V

CURRENT

AC

LUMENS

40 PER WATT

WARRANTY



In addition to the conditions of sale and warranties implied at law and which may not be excluded, Sunline Australia warrants LED Underwater Lights to be free from defect for a period of twelve months from the date of purchase by the owner from Sunline Australia or an authorized supplier of LED Underwater Light.

Light Globes are beyond the control of Sunline Australia and as such a limited guarantee of 60 days From the date of purchase applies. Sunline Australia will repair, or authorize a qualified technician to repair, The LED Light provided that:

- a) Sunline Australia is to be notified within seven (7) days of the defect being detected;
- b) The LED Light is not operated subsequent to detection of the defect; The LED Light has not undergone any unauthorized modification or
- c) Been fitted with other than genuine Sunline Australia approved parts;
- d) The LED Light has been installed and operated in accordance with the Installation Instructions and Operating Instructions, respectively.
- e) All repairs must be undertaken by Sunline Australia or a technician authorized by Sunline Australia.

The Owner will be responsible for all freight and/or traveling charges for Service. Sunline Australia accepts no responsibility for goods while in transit.

Sunline Australia will not be liable to repair LED Light if the repair is necessary because of misuse, accidental damage, and entry of foreign objects or materials into the equipment, improper or inadequate maintenance or repair or incorrect operation of LED Light.

This warranty does not extend to reasonable wear and tear of LED Light. To claim warranty a proof of purchase must be supplied.



CONTACT US

MELBOURNE

Address: 27 Westwood Drive, Deer Park, Vic 3023
Phone: (03) 9390 0700
Email: sales@sunlineaustralia.com.au
Web: www.sunlineaustralia.com.au

ADELAIDE

Address: 152 Frederick St, Welland SA 5007
0419 857 987
info@sunlinesa.com.au
www.sunlineaustralia.com.au

PERTH

Address: Unit 2, 10 Competition Way, Wangara WA 6065
(08) 9303 4347
info@sunlinewa.com.au

