



LED POOL LIGHTS



Luminous | Chic | Elegant

CREATE A RELAXED OUTDOOR EXPERIENCE WITH THE HIGHEST QUALITY UNDERWATER LIGHTING



Sunline LED pool lights are one of the most advanced, high performing and user friendly lighting systems available for swimming pools.

Sunline LED pool lights combine many unique features that result in a dazzling, dependable lighting system that's user friendly and aesthetically pleasing.

Sunline LED pool lights have a lower operating temperature than incandescent or halogen bulbs which has the advantage of less condensation forming on the lens and other lighting components.

The lower operating temperature also makes them more durable as the hotter temperature LED Swimming pool lights, produced by incandescent or halogen bulbs. Can cause seals and fixtures to deteriorate faster, this can cause leakages and ultimately lamp failure.

They are powered by a 12V AC transformer, making them very safe to use underwater. In the unlikely a event that water leakage occurs onto the conductors, the low voltage ensures that no body is at risk of electrical shock.

Sunline LED pool lights can be operated by remote control as an optional extra, so there is no need to turn switches on and off.

Niche



Surface Mount



Luminous | Chic | Elegant



DETACHABLE FACES

Sunline Niche Lights provide flexibility so that you can match the colour surround to your pool (grey, black, white and clear) that click fit with no visible fasteners. They're all interchangeable and are removed by twisting anti clockwise and installed by rotating clockwise to fit.

*Niche Light Only



INSTALLATION

Perfect for new concrete and fibre glass pool installations, and if desired can be retro fitted to other models. The kit comes complete with a detachable cable and integrated housing and easily fits into steps, swim outs, ledges and spa foot wells. Sunline Niche and Surface mount lights can be installed by a Sunline professional or you can do it yourself.



ELECTRICAL CORD

In every pack, there is 20 metres of electrical cable supplied so that there is absolutely no need to break the line when installing. This ensures quality, integrity and continuity of the electrical system.

*Niche Light Only



COLOURS

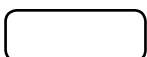

Sunline Niche lights provide ample illumination for even the largest pools and come in a range of six colour options. These colours can be changed easily with the flick of a button and can suit any mood.



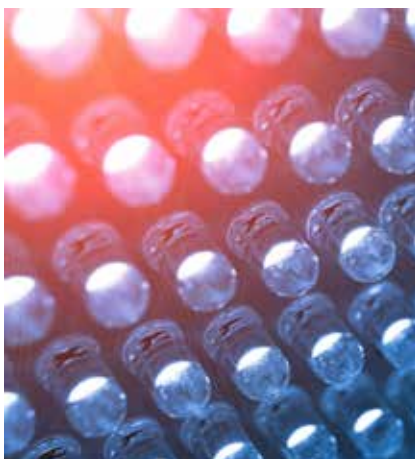

BRIGHT & ENERGY EFFICIENT



High-intensity single and multi-colour LED's provide ample illumination for even the largest pools that deliver maximum brightness with the lowest power consumption.

QUALITY DESIGN

Lightweight, compact and reliable, Sunline LED pool lights are designed in Australia for rigorous Australian conditions and standards.

*Surface mount shown



SEALED UNIT

The Injection-moulded, hard wearing PVC LED unit is completely sealed. This is to protect it from water damage and if the unit ever needs replacing its simply unplugged and another one is connected.

*Surface mount shown

WARRANTY

Sunline LED lights are covered by a comprehensive warranty*

Please see the website for up to date information

*terms and conditions apply.



NICHE LIGHT DIMENSIONS

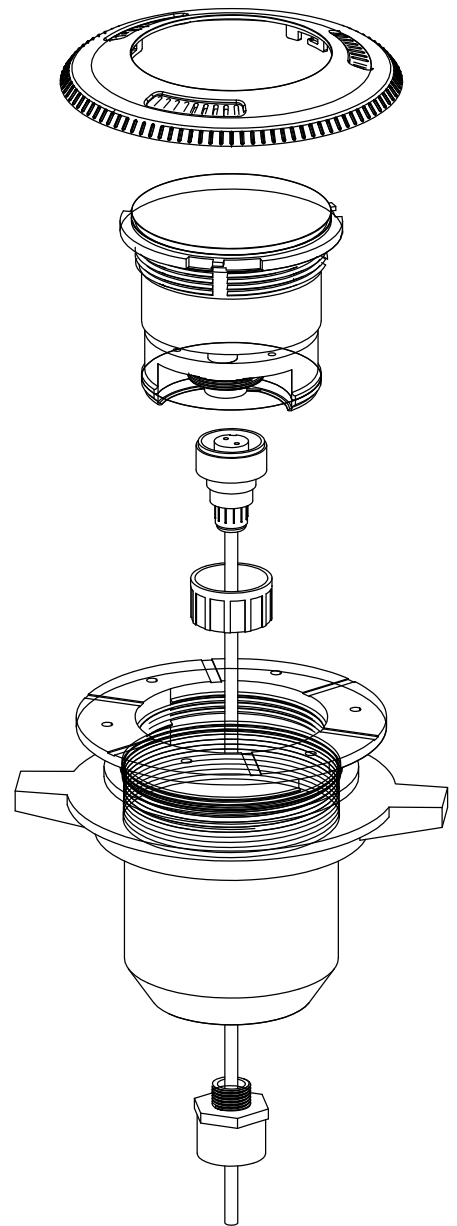
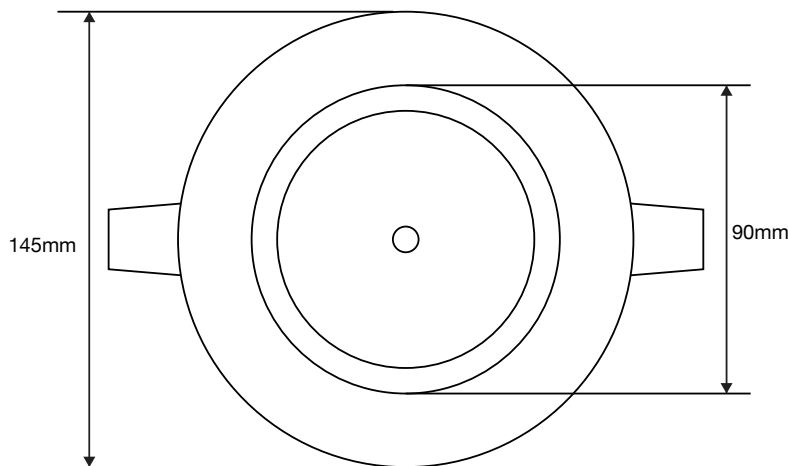
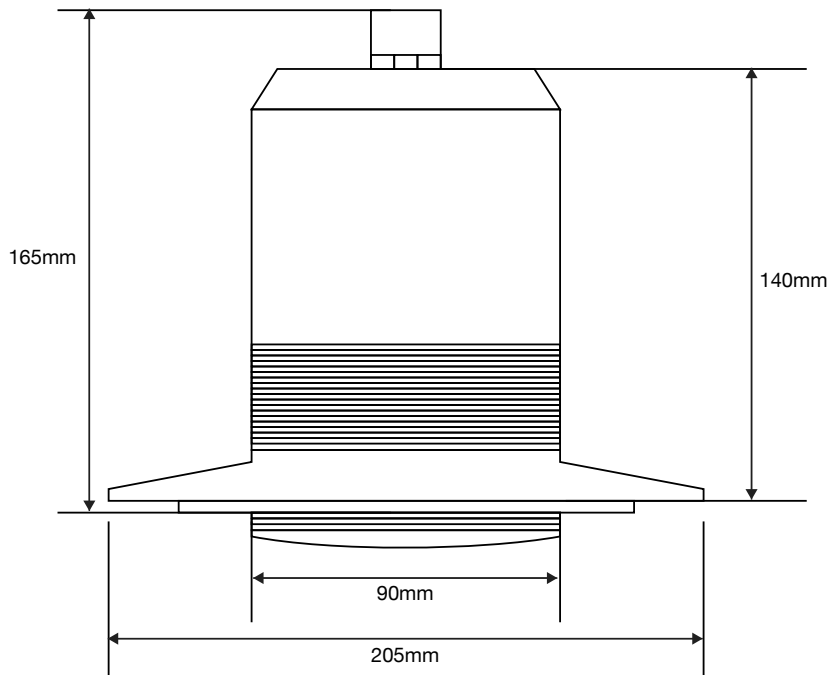

SPECIFICATIONS

Bright high intense LEDS deliver maximum brightness with the lowest power consumption (energy efficient) Input: 240V-AC 50Hz | Output: 12V-AC 50Hz.

Niche concrete pool, multi coloured model number: **SL-LED M-C: LED**

Niche fibreglass pool, multi coloured model number: **SL-LED M-F: LED**

HERTZ

50

OUTPUT

12V

INPUT

245V

CURRENT

AC

LUMENS

40 PER WATT

SURFACE MOUNT DIMENSIONS

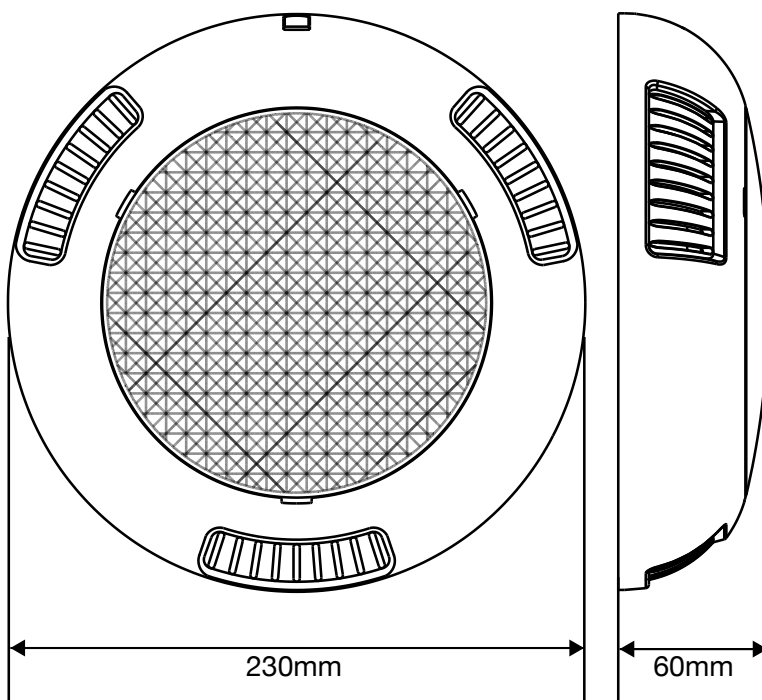

'Surface mount' version
Model No: SLSM LED 315

SPECIFICATIONS

MATERIAL

ABS

BULB

40 LEDs

CABLE

24 METERS

POWER

7W/12V

WATERPROOF STANDARD

IP68

LED Lights | www.sunlineaustralia.com.au



Luminous | Chic | Elegant



CONTACT US

MELBOURNE

Address: 27 Westwood Drive, Deer Park, Vic 3023
Phone: (03) 9390 0700
Email: sales@sunlineaustralia.com.au
Web: www.sunlineaustralia.com.au

ADELAIDE

Address: 152 Frederick St, Welland SA 5007
Phone: 0419 857 987
Email: info@sunlinesa.com.au
Web: www.sunlineaustralia.com.au

PERTH

Address: Unit 2, 10 Competition Way, Wangara WA 6065
Ph: (08) 9303 4347
Email: info@sunlinewa.com.au
Web: www.sunlineaustralia.com.au



[sunline_australia](#)



[sunline australia](#)



[sunlineaustralia](#)

Sunline Australia (SA) does not represent or warrant that the information accessible via this publication is accurate, complete or current. Price and availability information are subject to change without notice. ©Copyright 2016 SA. All rights are reserved.